

Sound Stages 1 & 2 Studio Map

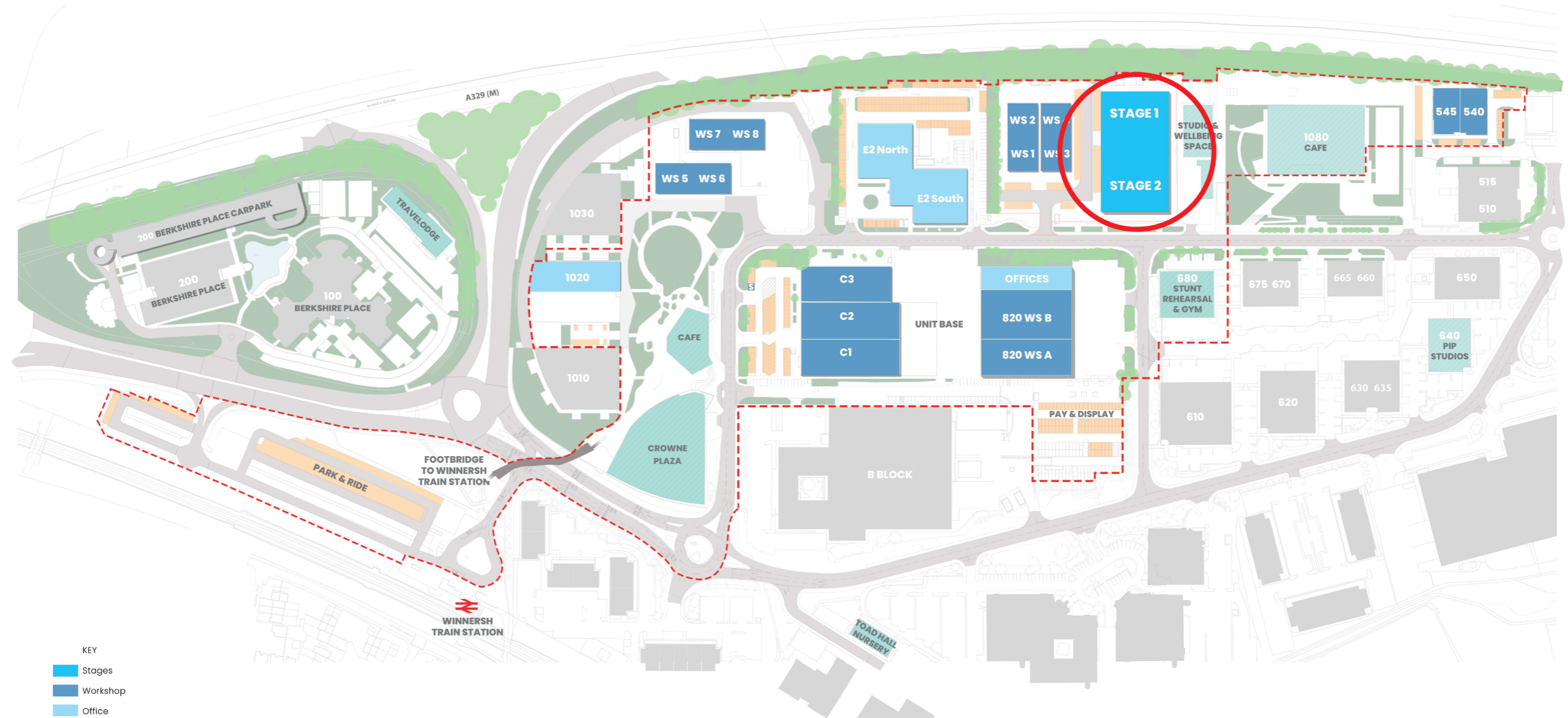

- KEY
- Stages
 - Workshop
 - Office
 - Costume Department
 - Preferred Partners
 - Parking
 - Security

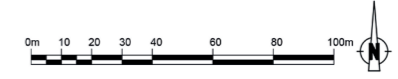

Sound Stages Stage 1

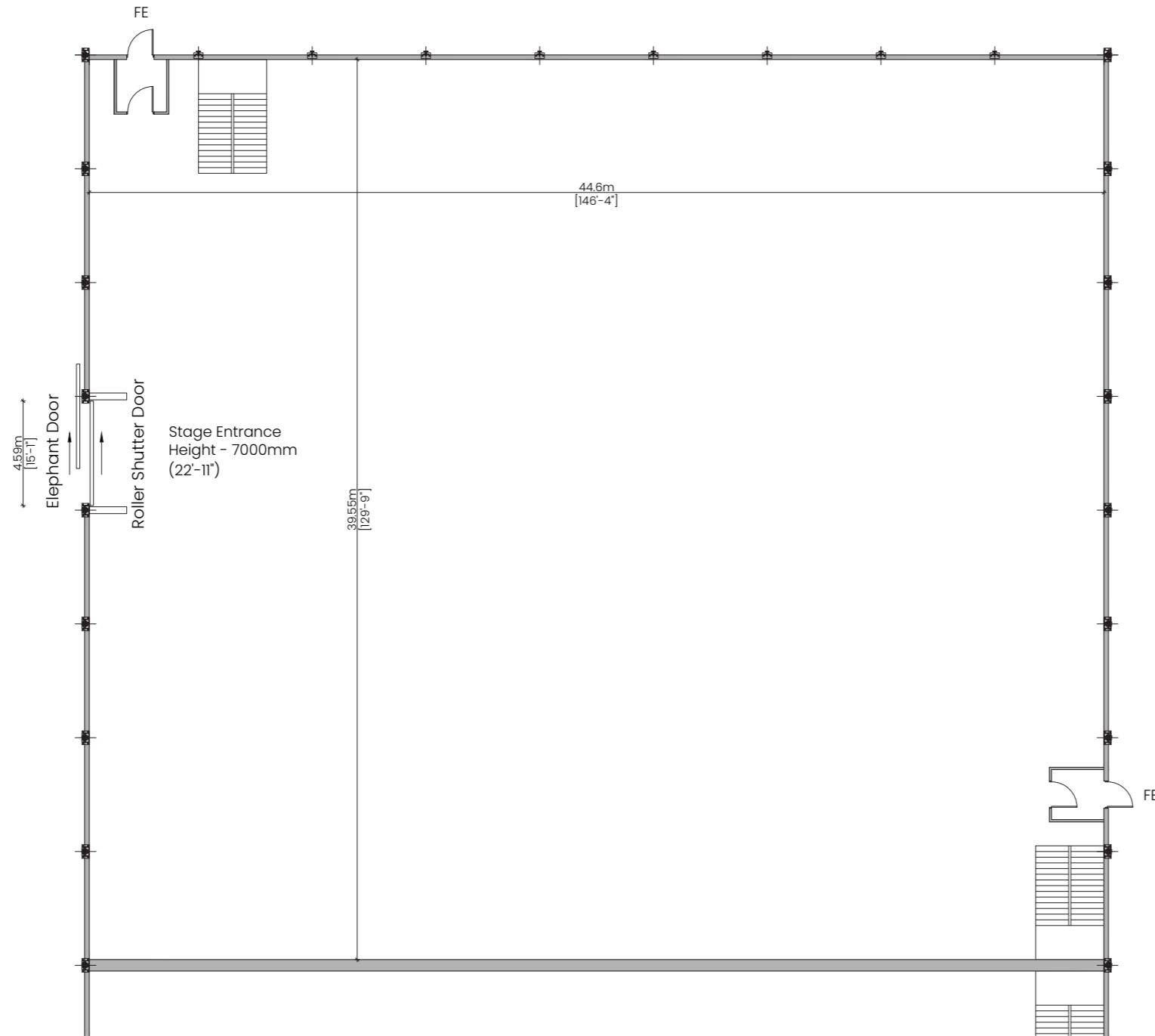

Key:

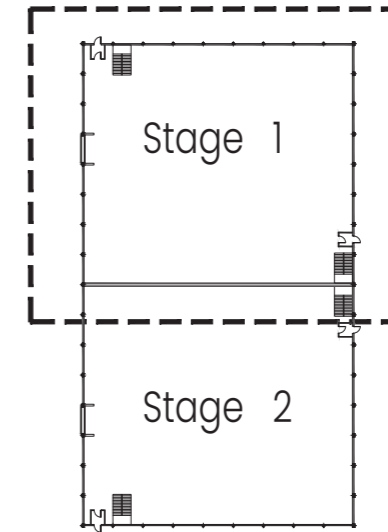

Stage 1
Gross Internal Area:
1,800 sq m / 19,375 sq ft



Sound Stages Stage 2

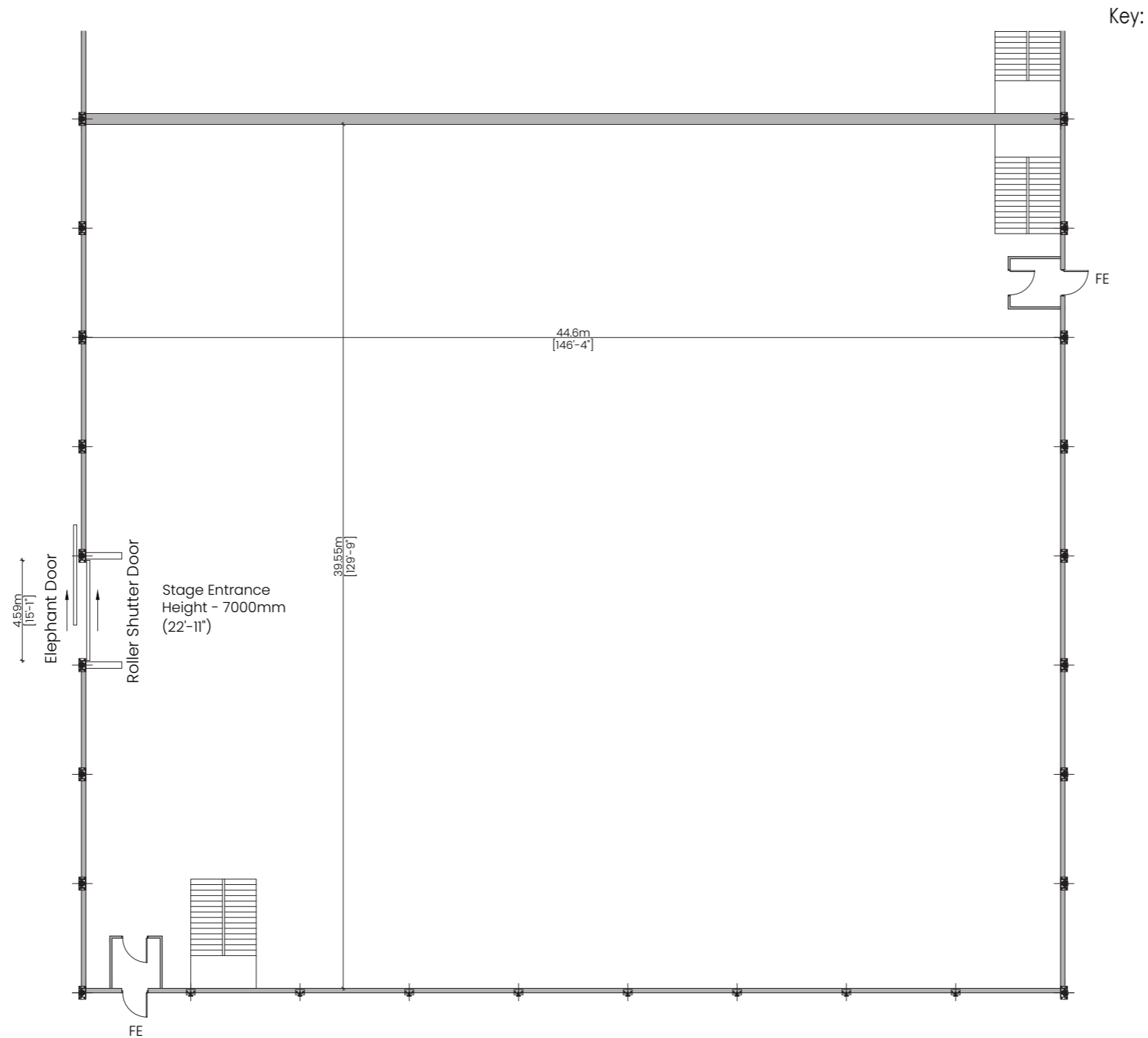

Key:

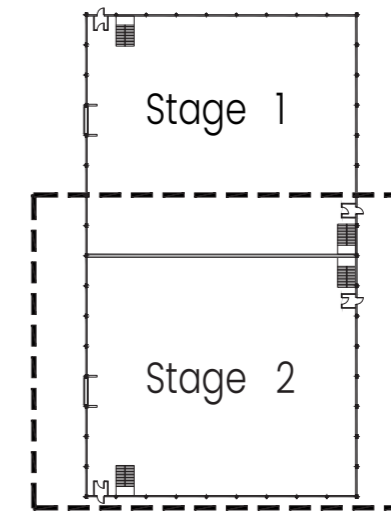

Stage 2

Gross Internal Area:
1,800 sq m / 19,375 sq ft



Facilities Overview

STAGES		
FACILITY	sq m	sq ft
Stage 1	1,800	19,300
Stage 2	1,800	19,300
Total	3,600	38,600

SPECIFICATION
Floor to beam working height 11.30m/37.6ft
Stage door 4.8m x 6m/15.7ft x 19.7ft
Floor loading built to withstand multiple plant activities
Power capacity 20,000 sq ft = 1500 KVA
HVAC powerful ventilation and AC industrial grade ATMOS system
Rigging weight 500KG per 5m X 2.5m/16.4ft x 8.2ft grid
50dB sound reduction as standard