

1-4 Workshops Studio Map

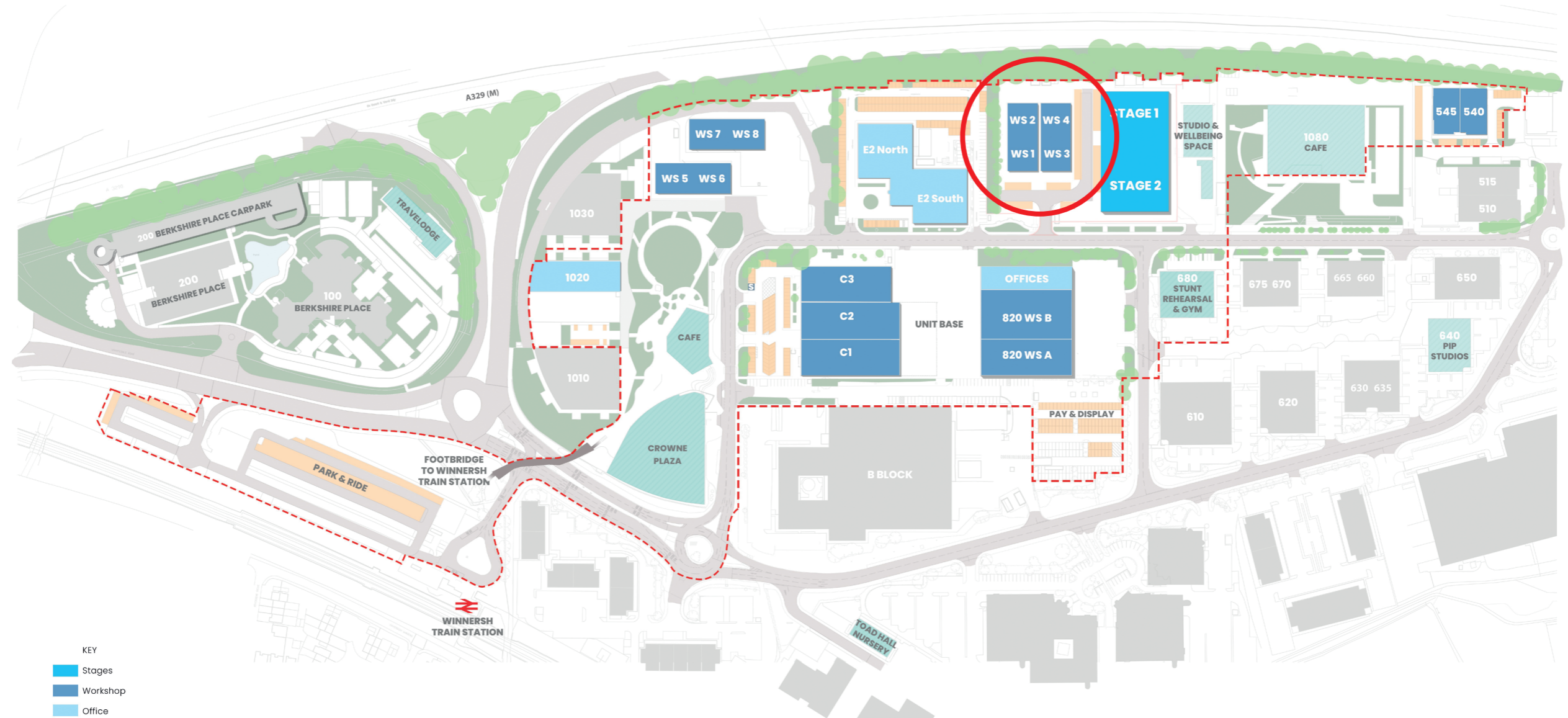

- KEY
- Stages
 - Workshop
 - Office
 - Costume Department
 - Preferred Partners
 - Parking
 - Security

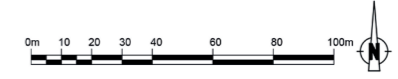

Workshops Workshops 1 & 2

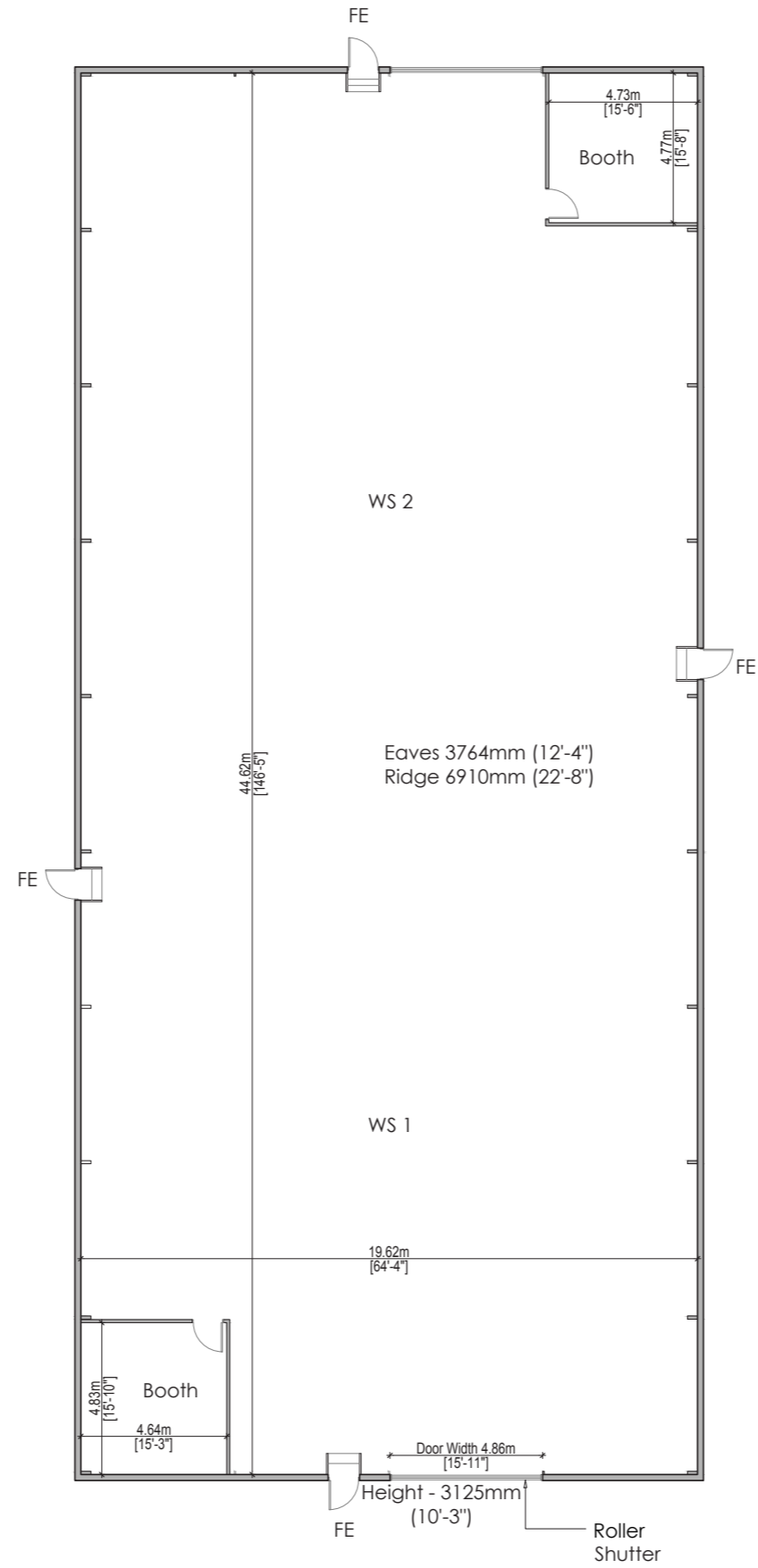

Workshop 1 & 2

Gross Internal Area:

WS 1: 389 sq m / 4,187 sq ft

WS 2: 486 sq m / 5,231 sq ft

Total: 875 sq m / 9,418 sq ft



Workshops
Workshop 3 & 4

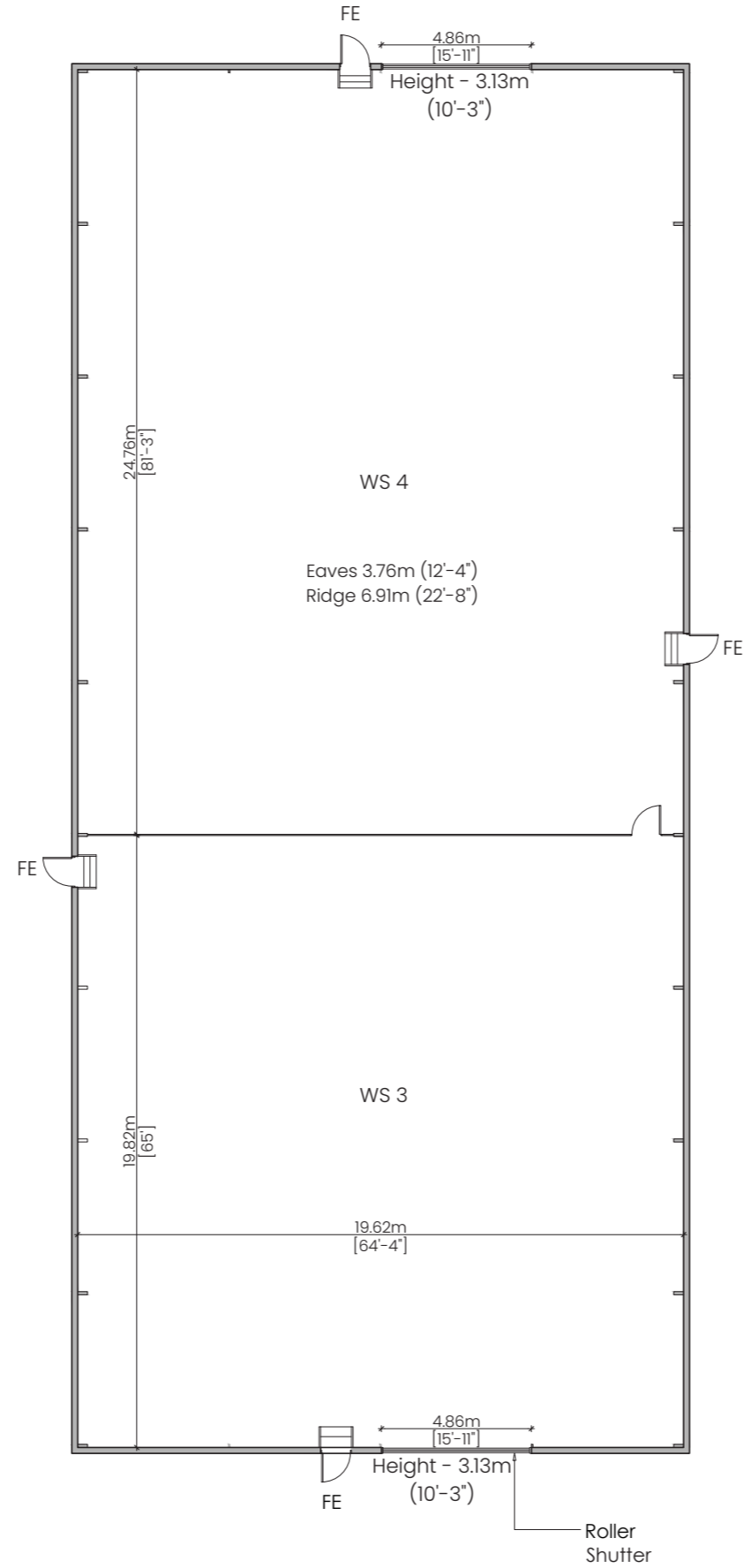

Workshop 3 & 4

Gross Internal Area:

WS 3: 389 sq m / 4,187 sq ft

WS 4: 486 sq m / 5,231 sq ft

Total: 875 sq m / 9,418 sq ft



Facilities Overview

WORKSHOPS 1-4		
FACILITY	sq m	sq ft
WORKSHOP 1	389	4,187
WORKSHOP 2	486	5,231
WORKSHOP 3	389	4,187
WORKSHOP 4	486	5,231
Total	1,750	18,836

SPECIFICATION
Floor to eaves working height 3.76m/12.33ft
Roller door 4.86m/15.92ft wide 3.13m/10.25ft high
Power Capacity 3 phase power
Heating